

APR 22 1975

FORM 9-1642 (1-68)

PUNCHED WELL SCHEDULE

Well No. G32

E log # 108

PUNCHED

U. S. DEPT. OF THE INTERIOR

GEOLOGICAL SURVEY

WATER RESOURCES DIVISION

DEC 16 1974

MASTER CARD

Bowc

Record by WTO Source of data Obs driller Date 10-31-73 Map POPLARVILLE QUAD.

State MISS. County (or town) 2:8 Pearl River 5:5

Latitude: 30° 50' 34" N Longitude: 089° 32' 02" W Sequential number: 1

Lat-long accuracy: 1 T 2 N 3 R 15 E Sec 30 SE

Local well number: G0328D3002S15W Other number: _____ B & M

Local use: 088108 67430 Owner or name: _____

Owner or name: POPLARVILLE Address: _____

Ownership: County, Fed Gov't, City, Corp or Co, Private, State Agency, Water Dist M

Use of water: (A) Air cond, Bottling, Comm, Dewater, Power, Fire, Dom, Irr, Med, Ind, P S, Rec, (S) Stock, Instit, Unused, Repressure, Recharge, Desal-P S, Desal-other, Other P

Use of well: (A) Anode, Drain, Seismic, Heat Res, Obs, Oil gas, Recharge, Test, Unused, Withdraw, Waste, Destroyed. H

DATA AVAILABLE: Well data Freq. W/L meas.: Field aquifer char. Z

Hyd. lab. data: _____

Qual. water data; type: USGS Complete

Freq. sampling: Pumpage inventory: no. period: _____

Aperture cards: _____

Log data: 65'-12302' DE

WELL-DESCRIPTION CARD

Depth well: 618' Meas. 3

SAME AS ON MASTER CARD Depth well: 1608' Meas. 3

Depth cased: 528' Casing type: _____; Diam. 12x8 in 12

Finish: (C) porous concrete, (F) gravel w. concrete, (G) gravel w. (perf.), (H) horiz. gallery, (O) open end, (P) perf., (S) screen, (T) sd. pr., (W) shored, (X) open hole, (Z) other S

Method Drilled: (A) air rot, (B) bored, (C) cable, (D) dug, (H) hyd jetted, (J) air rot., (P) air percussion, (R) reverse, (T) trenching, (V) driven, (W) drive wash, (Z) other H

Date Drilled: 10-31-73 973 Pump intake setting: 8' 329' ft 36 38

Driller: SWITZER

Lift (type): (A) air, (B) bucket, (C) cent, (J) multiple, (L) above MP, (M) multiple, (N) none, (P) piston, (R) rot, (S) submerg, (T) turb, (Z) other T Deep Shallow

Power (type): (nat) diesel, elec, gas, gasoline, hand, gas, wind; H.P. 60 Trans. or meter no. _____

Descrip. MP _____ ft above LSD, Alt. MP _____

Alt. LSD: 320 Accuracy: topo 20' 4

Water Level: _____ ft above MP; _____ ft below LSD 198 Accuracy: 6/29 dry test D

Date meas: 874 Yield: @25' gpm 500 Method determined 1

Drawdown: _____ ft Accuracy: _____ Pumping period _____ hrs _____

QUALITY OF WATER DATA: Iron _____ ppm Sulfate _____ ppm Chloride _____ ppm Hard. _____ ppm

Sp. Conduct 80 k x 10⁶ 1 Temp. 230 °F Date sampled 6/3/74 674

Taste, color, etc. pH 5.6 Clear

10/12/81 WL-20553

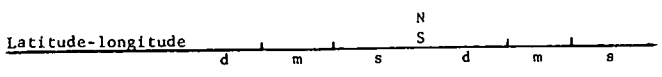

HYDROGEOLOGIC CARD

SAME AS ON MASTER CARD Physiographic Province: 03 Section: _____

Drainage Basin: D Subbasin: 135

Topo of well site: (D) depression, (C) stream channel, (E) dunes, (F) flat, (H) hilltop, (K) sink, (L) swamp, (P) offshore, (S) pediment, (T) hillside, (U) terrace, (V) undulating, valley flat. H

MAJOR AQUIFER: system T series TM aquifer, formation, group MZ

Lithology: S Origin: 3 Aquifer Thickness: 95 ft

Length of well open to: 110 ft Depth to top of: 80 ft 520 ft

MINOR AQUIFER: system _____ series _____ aquifer, formation, group _____

Lithology: _____ Origin: _____ Aquifer Thickness: _____ ft

Length of well open to: _____ ft Depth to top of: _____ ft

Intervals Screened: _____

Depth to consolidated rock: _____ ft Source of data: _____

Depth to basement: _____ ft Source of data: _____

Surficial material: _____ Infiltration characteristics: _____

Coefficient Trans: 75,000 gpd/ft 753 Coefficient Storage: _____

Coefficient Perm: 680 gpd/ft²; Spec cap: 30 gpm/ft; Number of geologic cards: _____

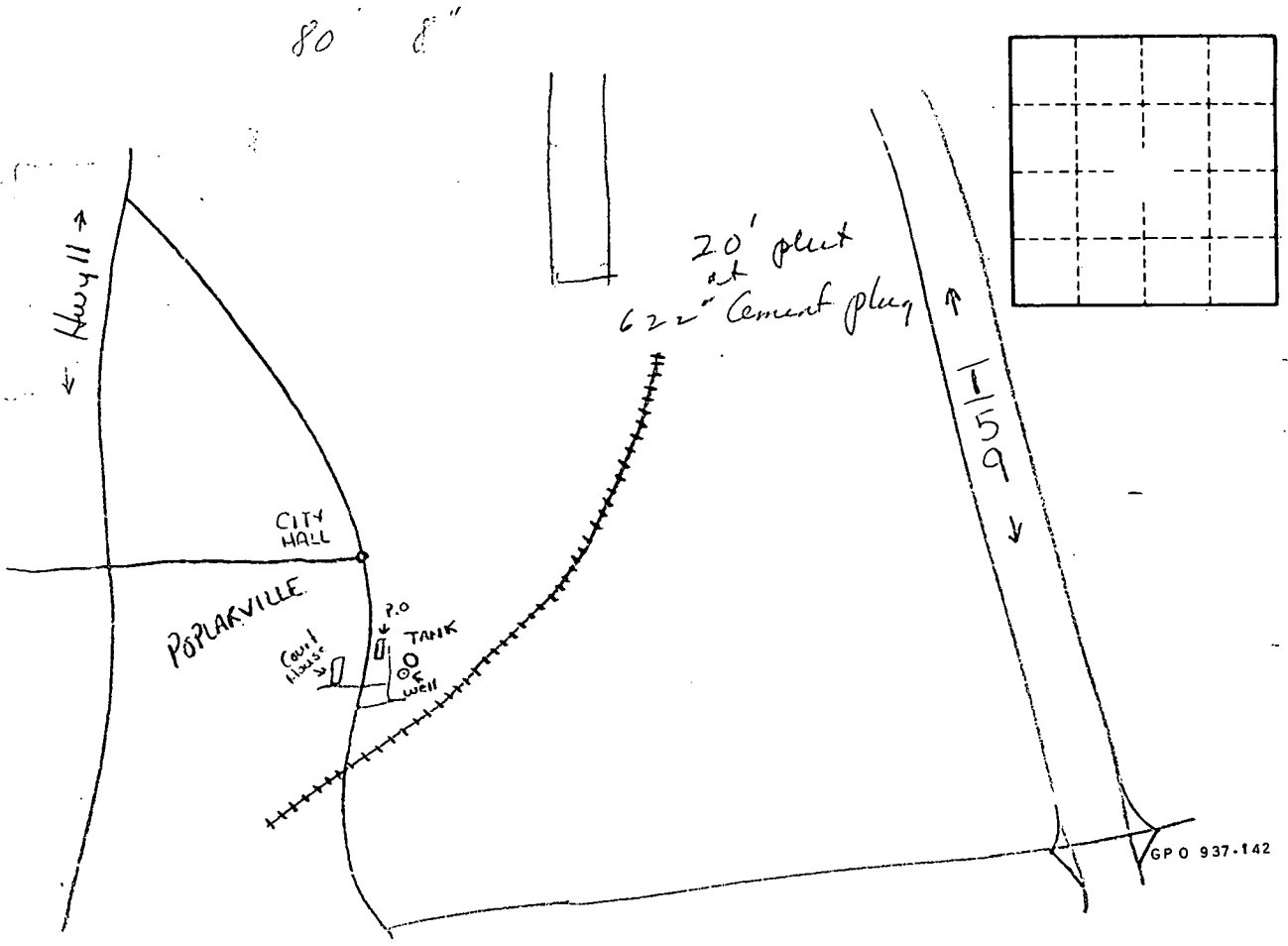

Well No. G32